

CEILING SYSTEMS  
FIRE RATED

# 710 series

## F90



A clip in hinge down ceiling type, clipped in to a concealed suspension system with non-perforated finish making it an ideal solution for industrial & central kitchens. Fire resistance performance close to 2 hours, and classified as medium security. Hinge down accessibility using panel removal access key tool. Offered in a wide range of sizes, colors & finishes .

## FEATURES

### MATERIAL

Zinc Plated Galvanized Steel G90 grade.

### THICKNESS

Galvanized Steel:  
0.7mm

### SURFACE FINISH

Plain  
Perforated  
Decorative Patterns

### SIZE

PANEL JOINT DETAIL (mm)

Square:

$W \leq 600\text{mm} \times L \leq 1800\text{mm}$

3mm Beveled:

600x600

+ Custom sizes are available upon request

### COATING

Polyester Coating: ( $5\mu$  (Back) +  $20\mu$  (Face))

Polyester Powder Coating: ( $70\mu$  -  $80\mu$ )

+ High Performance Coatings like PESDF, PVDF and POLYAMIDE are available upon request.

### INSULATION

**Acoustic Black Fleece** is non-flammable and meets the standard DIN 4102 / B1. Classification A1 according to EN 13501-1.

**Rockwool** slabs conforming to ASTM C612 and equivalent BS 3958-5 are provided for acoustic insulation.

### COLORS

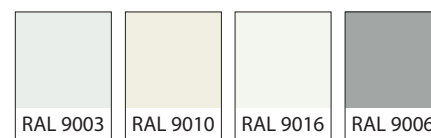

### SPECIAL FINISHES



+ See [www.dorsoram.com](http://www.dorsoram.com) for additional colors & special finishes available

+ Special finishes can be provided in lamination, sublimation or coil coating process.

### PERFORATION PATTERNS

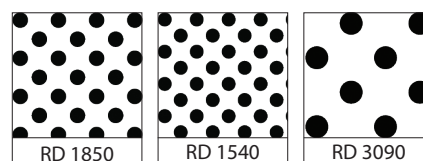

+ See [www.dorsoram.com](http://www.dorsoram.com) for all available pattern options

## DATA / PERFORMANCE



### ACOUSTICS

Tested as per BS EN ISO 354: 2003 for sound absorption, noise reduction and sound attenuation.

NRC achieved with Acoustic Black fleece – NRC 0.75

NRC achieved with Acoustic Black Fleece and Rockwool Insulation – NRC 1.00

Tested as per ASTM E1414-11a for Airborne Sound Attenuation as per ISO 10848-2.

CAC can achieved up to – 48 dB

Perforated & Sound Attenuation cover



### ANTI BACTERIAL COATING

Tested as per JIS Z 2801: 2000, which inhibits the growth of bacteria on the applied surface.



### LIGHT REFLECTANCE (LR)

Achieved by the metal ceiling is LR – 0.85-0.96 tested as per ASTM E 1477.



### FIRE RESISTANCE

Fire Rated up to 115 minutes tested as per BS476: Part 23: 1987

## RAM 711 F90

### ISOMETRIC DETAIL

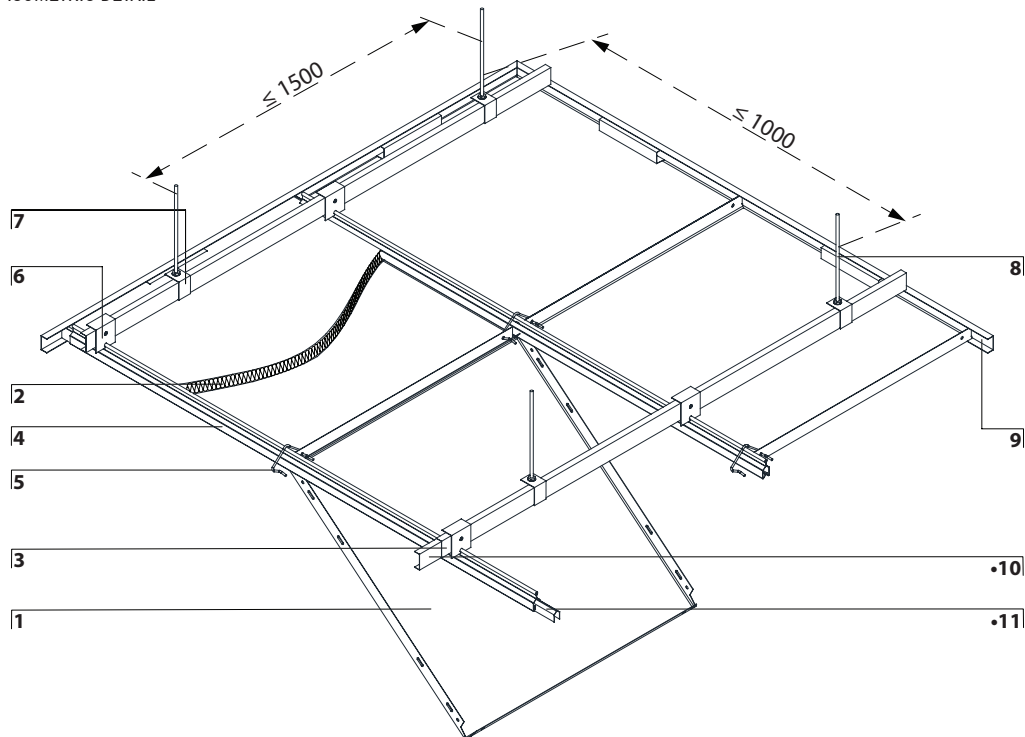

### COMPONENTS

- 1 Panel
- 2 Rockwool Infill
- 3 Stabilizer
- 4 Narrow Carrier
- 5 Security Clip
- 6 NC Bracket
- 7 ST Bracket
- 8 Threaded Rod
- 9 Wall Trim
- 10 ST Splice •
- 11 C Splice •
- 12 Wedge •
- 13 Anti-Vibration Clip (TR) •

• Optional

Custom sizes can be offered

### SECTION DETAIL

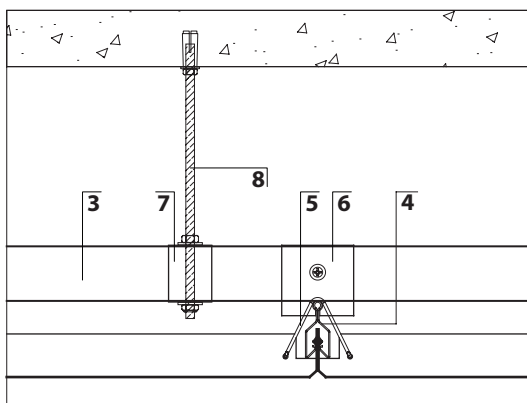

### JOINT DETAILS



### PERIMETER OPTIONS

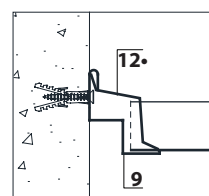
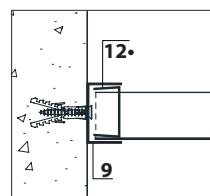

### ACCESS TOOL •

